



SKYLINECHODOV.CZ

Non-residential unit no.628

POSITION WITHIN THE BUILDING



POSITION WITHIN FLOOR



by
PSN

UNIT PLAN

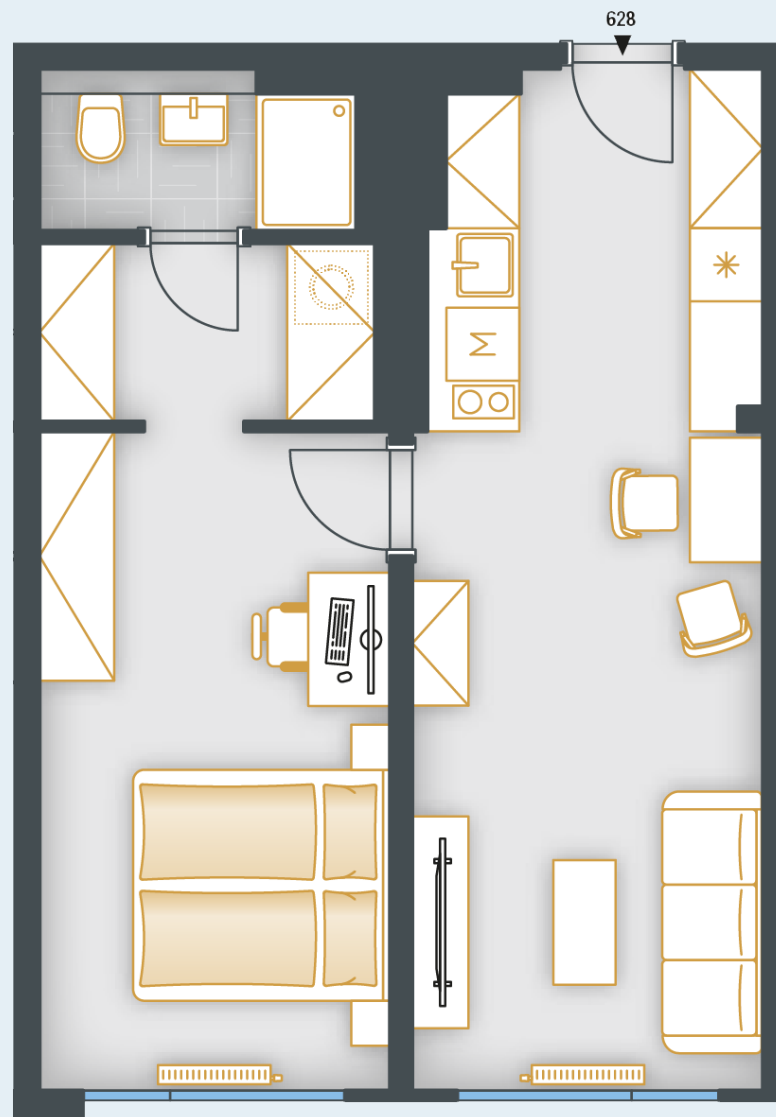

BASIC INFORMATION

| | |
|------------------------|-------------------------|
| property ID | SKY628 |
| Disposition | two rooms + kitchenette |
| Floor | 6 |
| Orientation | |
| Lift | Yes |
| Type of building | Concrete |
| Status at the handover | Fit out |
| Parking | No |

ACREAGES

| | |
|-----------------------|-------------------------|
| Hall | 7.5 m ² |
| Room | 15 m ² |
| Room | 14.9 m ² |
| Šatna | 3.9 m ² |
| Bathroom | 3.2 m ² |
| Vertical construction | 1.5 m ² |
| Floor area | 46 m² |
| Cellar stall | 1 m ² |
| Overall area | 47 m² |

Note: The unit's floor area is calculated in accordance with Regulation No. 366/2013 Coll., as amended. Areas of individual rooms are for information only. The equipment shown in the plans (furniture, kitchen unit, electrical appliances, luminaires, etc.) are not included. The exact parameters are specified in the contractual documents. The developer reserves the right to make minor modifications. Any change in the layout or materials is subject to compliance with generally binding building and legal regulations.

The unit is finished up to the final surfaces, including sanitary ware, and contains the preparatory points for the kitchen installations.

