



SKYLINECHODOV.CZ

no.311

POSITION WITHIN  
THE BUILDING



POSITION WITHIN FLOOR



by  
**PSN**

UNIT PLAN

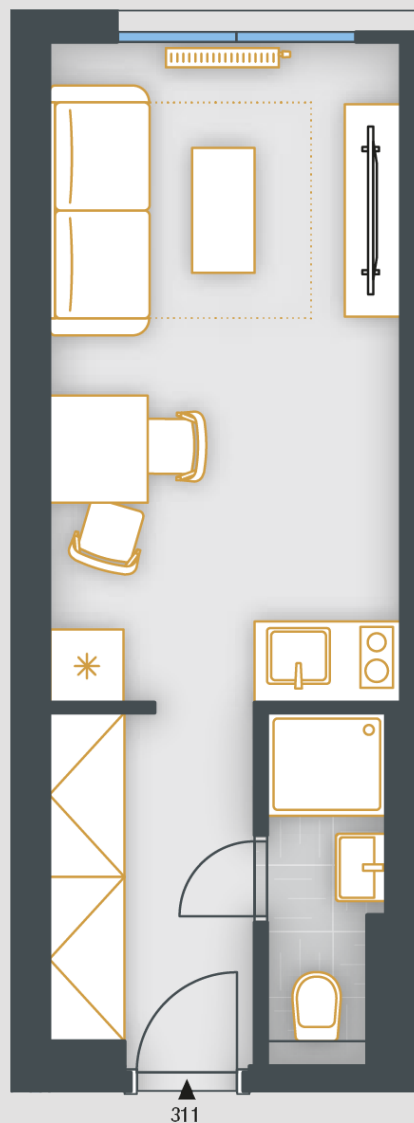

BASIC INFORMATION

property ID	SKY311
Layout	one room + kitchenette
Floor	3
Orientation	
Lift	Yes
Type of building	Concrete
Status at the handover	Fit out
Parking	No

ACREAGES

Předsíň	4.7 m <sup>2</sup>
Bathroom	2.6 m <sup>2</sup>
Room	14.9 m <sup>2</sup>
Vertical construction	0.4 m <sup>2</sup>
<b>Floor area</b>	<b>22.6 m<sup>2</sup></b>
<b>Overall area</b>	<b>22.6 m<sup>2</sup></b>

Note: The unit's floor area is calculated in accordance with Regulation No. 366/2013 Coll., as amended. Areas of individual rooms are for reference only. The equipment shown in the plans (furniture, kitchen unit, electrical appliances, luminaires, etc.) are not included. The exact parameters are specified in the contractual documents. The developer reserves the right to make minor modifications. Any change in the layout or materials is subject to compliance with generally binding building and legal regulations.

The unit is finished up to the final surfaces, including sanitary ware, and contains the preparatory points for the kitchen installations.

